

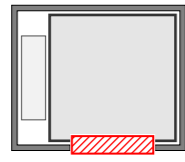

Model	STAR 450	STAR 630	STAR 1000
Capacity	450 KG 6 persons	630 KG 8 persons	1000 KG 13 persons
Car dimensions (W x D)	1000 x 1250 mm	1100 x 1400 mm	1400 x 1600 mm; 1100 x 2100 mm
Pit depth	150 mm	150 mm	150 mm
Headroom	2500/2850 mm	2500/2850 mm	2500/2850 mm
Speed	0.15m/s (up to 0.3m/s outside UE)	0.15m/s (up to 0.3m/s outside UE)	0.15m/s (up to 0.3m/s outside UE)
Maximum travel	15 m	15 m	15 m
Nominal power	starting from 2,2 kW	starting from 2,9 kW	starting from 2,9 kW
Power supply	1 x 240 V	1 x 240 V	1 x 240 V

Flexible entrances arrangement
dimensions upon request *



single entrance

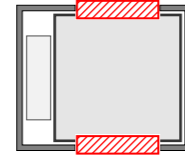

double/opposite

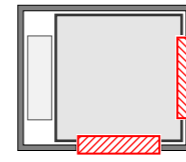

double/adjacent *

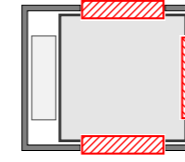

triple *

STAR is a price convenient, flexible **hydraulic MRL platform**

Space saving compared to the traction solution of the same capacity

Intended for both **domestic** and **commercial** market

STAR can be installed in traditional lift shaft or can be supplied with **self-supporting structure**

Available in a broad variety of **customized finishing**, colors and materials basing on customer's needs and building design

Conformity: European directive 2006/42/CE

Applications

Residential/Domestic, Light Commercial, Care & Nursing, Retail, Public

Main features

Space saving design
DDA compliance
Single Phase electric supply
Fully enclosed cabin for passenger comfort
Aesthetic flexibility of cabin finishes

Structure Options

Traditional shaft, Timber frame, Glass structures



PANELS AND LANDING STATIONS

Our company offers a wide range of high quality car operating panels and landing push stations with a choice of LED or LCD indicator displays in a range of configurations.

All operating panels and push stations can be tailored to the individual project and to coordinate with the building décor, as well as other features such as handrails (see below), mirrors (half wall/full wall glass) or ceiling (lights).



Rectangular



Round

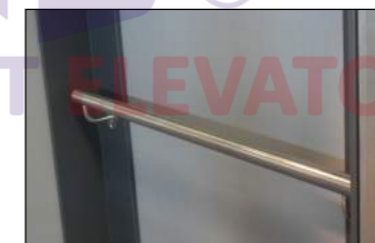

With pipe fittings

QUALITY CERTIFICATES

NovaElex can guarantee the quality of its products thanks to their compliance with the latest international quality standards and the achievement of certificates issued and granted by the most important international organisms for the quality of goods.



Quality management system **ISO 9001:2015**



STAR lift compliance with Annex IX of directive **2006/42/EC**



Conformity of electric and hydraulic lifts to Annex XI of directive **2014/33/UE**

FINISHING

NovaElex provides a broad range of finishes and materials to complement the product and meet your requirements. We also offer a huge selection of **ARPA Laminates** and **ABET Laminates** (please ask your retailer for more details). In addition we welcome the opportunity to work with Architects, Interior Designers and Specifiers to design a bespoke cabin solution.



WALLS

Laminates
Painted Steel
Skinplate
Stainless Steel

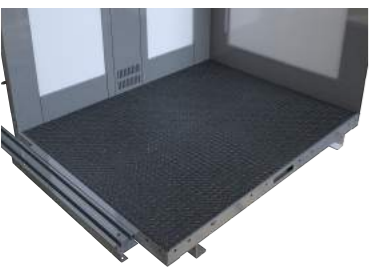

FLOOR

PVC
Rubber
Linoleum

Please remember that products availability may vary due to their presence in stock.

*Non standard finishings; they may imply an extra cost

LAMINATES



PAINTED ST.



SKINPLATE

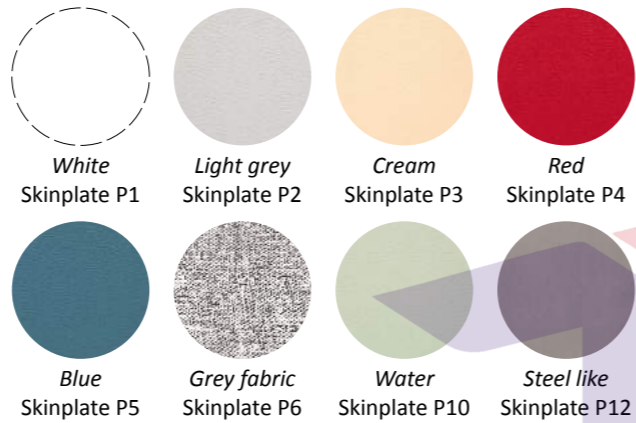

STAINLESS ST.

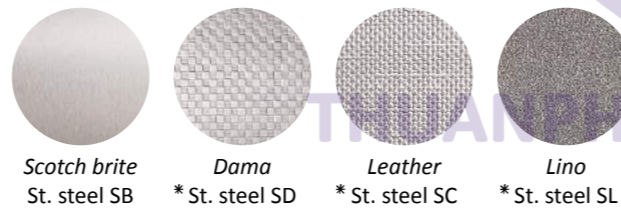

CUSTOM EXECUTIONS
It is possible to design customized car wall finishes (wood, glass...) or to provide bare car cage/floor for local fitting by the user

PVC

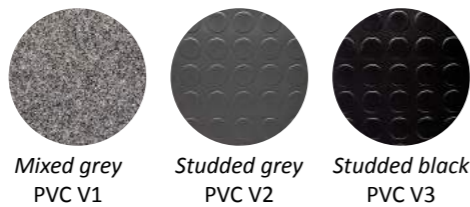

RUBBER



LINOLEUM

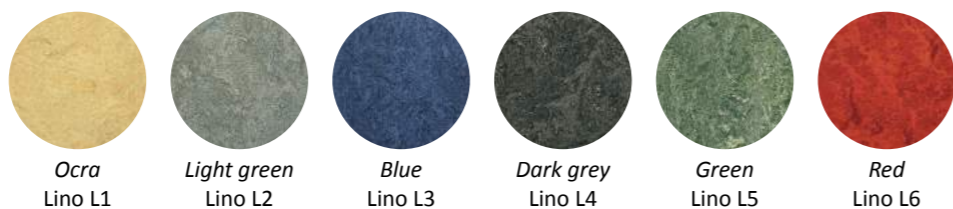

STAR 450

1000 x 1250 mm

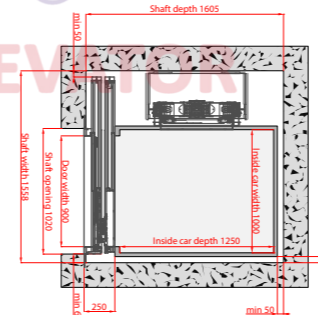
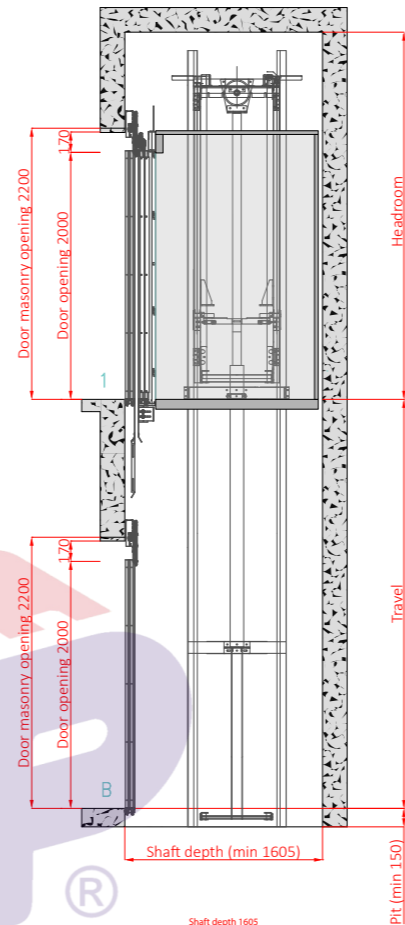

STAR 630

1100 x 1400 mm

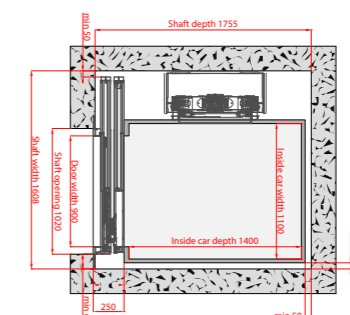
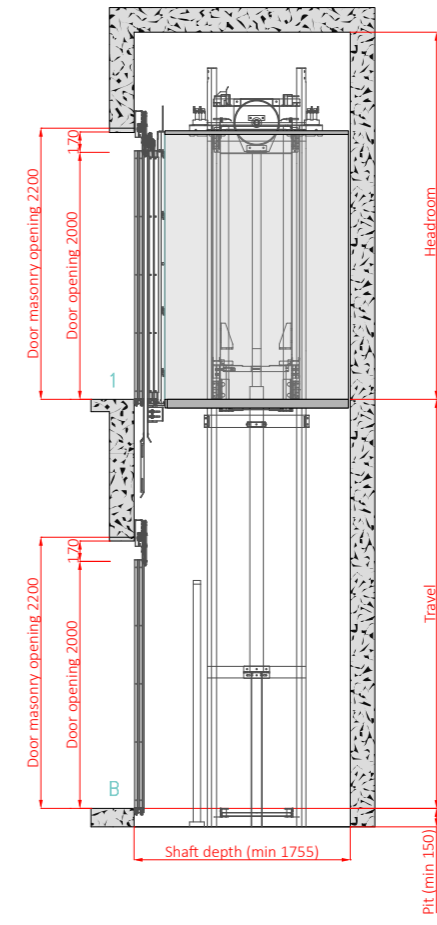

STAR 1000

1400 x 1600 mm
1100 x 2100 mm

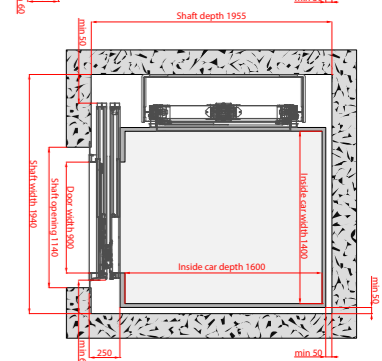
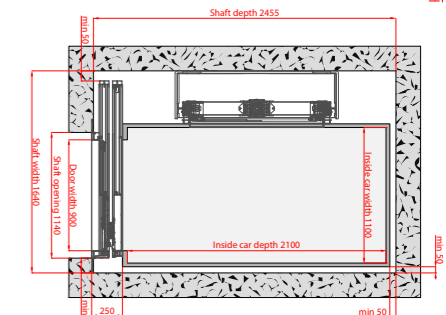
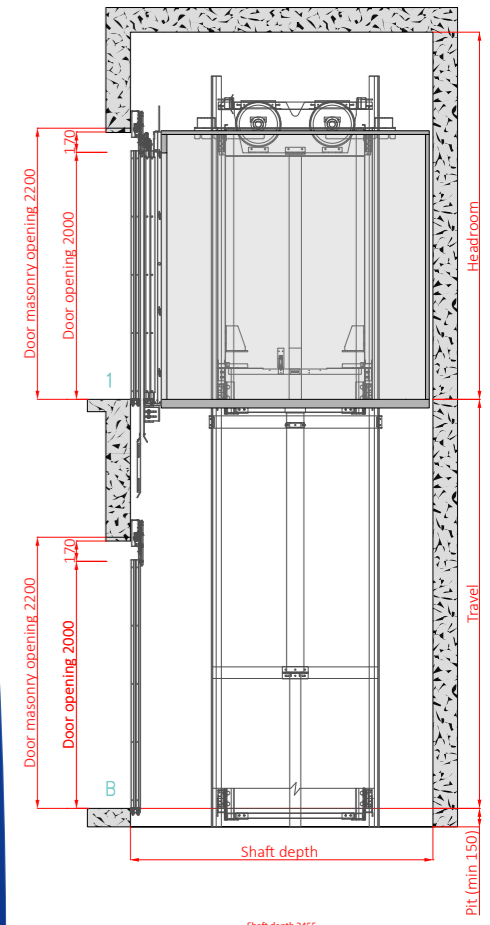

We provide drawings of our standard dimensions car equipped with 900mm automatic doors with single side opening. If you need technical drawings about other models you can ask for them to your retailer.

STANDARD DIMENSIONS

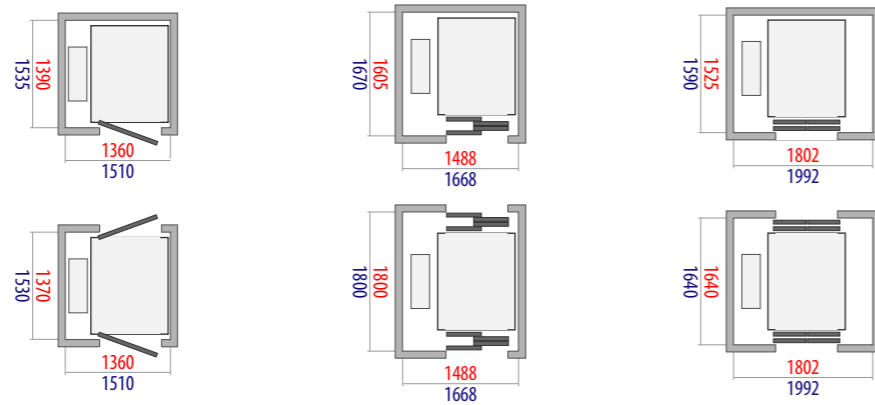

Capacity **450 Kg** Car dim. 1000 x 1250 mm Door size 800 mm

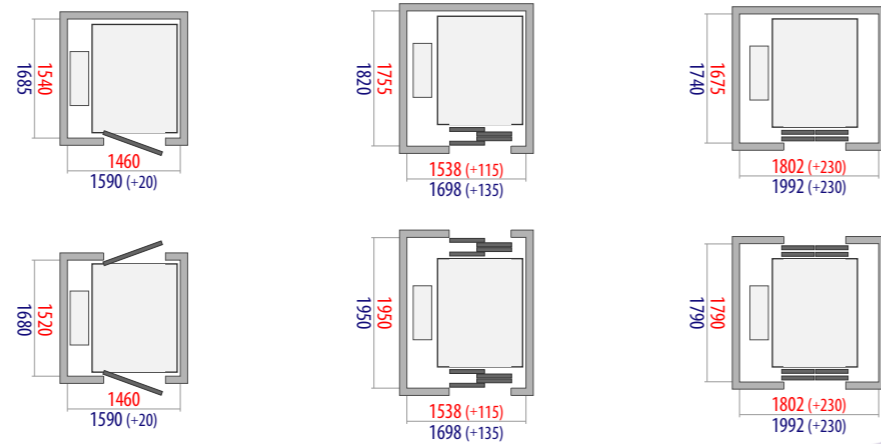

Capacity **630 Kg** Car dim. 1100 x 1400 mm Door size 800/900 mm

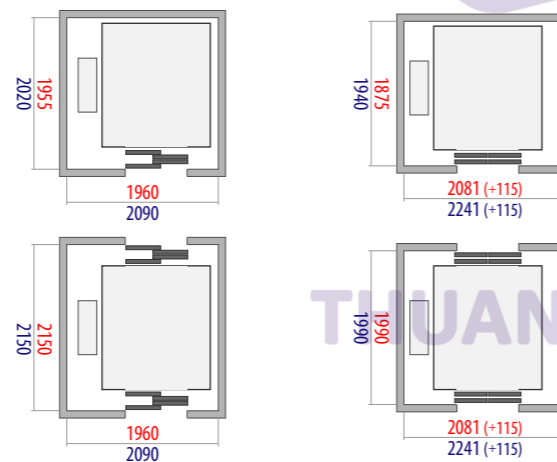

Capacity **1000 KG**
Car dim. 1400x1600 mm
Door size 800 / 900 mm

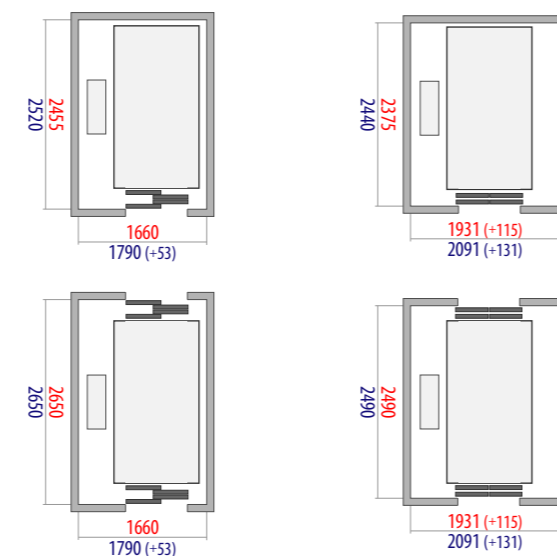

Capacity **1000 KG**
Car dim. 1100x2100 mm
Door size 800 / 900 mm

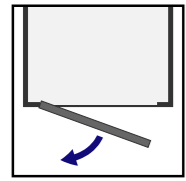

manual doors

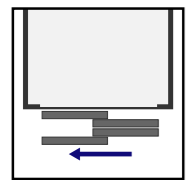

automatic doors side opening

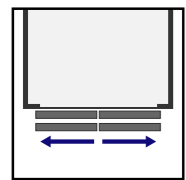

automatic doors central opening

minimum shaft dim. without structure

minimum shaft dim. with structure

(+XXX mm)

brackets show dim. for 900mm doors

METAL STRUCTURES

When the shaft is not at plumb, or in case of timber framed buildings or outdoor lifts, it is possible to request a metal structure fitting every situation.

We can provide **standard structures** to fit into the existing shaft, or **self-supporting** structures (no shaft needed) and even structures with **glass cladding** on the side.

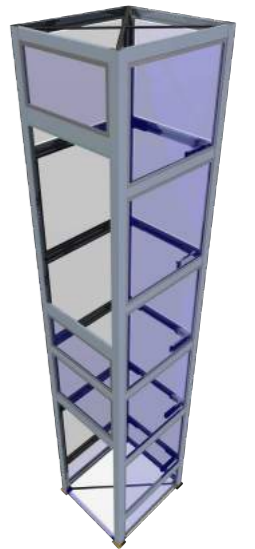

STANDARD DOORS

The range of our products goes from the classic hinged manual doors (*above*) up to the automatic ones (*below*).

Manual doors can be equipped with different sized windows: you can choose between a small opening or a full glass framed door.

Automatic doors may open centrally or on the side. They can come in various finishings: RAL painted, skinplate, stainless steel.

All models may be provided in full glass with metal frame upon customer request.

